

LEGAL DESCRIPTION & ADDRESS

LOT 1 THRU 10 & ADJ. ALLEY, BLOCK 77, FORT CONCHO
ADDITION, SAN ANGELO, TOM GREEN COUNTY, TEXAS
702 SOUTH CHADBOURNE STREET

PARKING:

PROPOSED USE: ASSEMBLY 1 SPACE/400 sq ft
TOTAL SPACES REQUIRED: 5 SPACES
TOTAL SPACES PROVIDED: 34 SPACES
ADA SPACES: 1 HANDICAP SPACE/25 SPACES
HANDICAP SPACE REQUIRED: 1
HANDICAP SPACES PROVIDED: 2

KEYED NOTES:

- [A] CONCRETE ENTRANCE - CONTRACTOR TO OBTAIN PERMIT FROM CITY OF SAN ANGELO AND BUILD TO APPLICABLE STANDARD.
[B] ACCESSIBLE PARKING SPACES, SIGNAGE, WHEEL STOP, AND ACCESS AISLE.
[C] 4" WIDE, YELLOW PARKING SPACE STRIPING.
[D] 4" WIDE, YELLOW STRIPING @ 24" O.C.E.W.
[E] WHEEL STOPS.
[F] PARALLEL PARKING.
[G] ACCESSIBLE RAMP PER TAS DETAILS.
[H] STAIRS WITH HANDRAILS.
[I] PROPOSED 2" PVC SCH40 SLEEVE 24" DEEP
[J] PROPOSED 18" RIBBON CURB
[K] CURB RAMP
[L] SIDEWALK IN CITY R.O.W. PER COSA DETAIL S-FF-1
[M] CURB AND GUTTER IN CITY R.O.W. PER COSA DETAIL S-T-1. INFILL WITH HOT-MIX COLD LAY WHERE NECESSARY.
[O] YELLOW DIRECTIONAL ARROW. 8' LONG NOMINAL SIZE
[P] 6" CURB

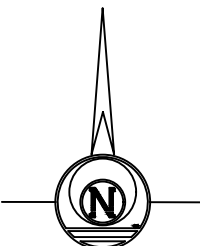

LEGEND

- PROPERTY LINE
EXISTING BUILDING
PROPOSED BUILDING
STANDARD DUTY ASPHALT PAVEMENT
HEAVY DUTY ASPHALT PAVEMENT
PROPOSED CONCRETE
PROPOSED CURB AND GUTTER

GENERAL NOTES:

1. DIMENSIONS SHOWN HEREON ARE TO THE BACK OF CURB, CENTERLINE OF STRIPING, OR BUILDING FACE.
2. EXISTING CONDITIONS, UTILITIES, SETBACKS AND EASEMENTS SHOWN HEREON ARE PROVIDED BASED ON A SURVEY PREPARED BY SKG ENGINEERING.
3. EXISTING CONDITIONS, UTILITIES, SETBACKS AND EASEMENTS REPRESENT THE BEST INFORMATION AVAILABLE AND SHOULD NOT BE CONSTRUED AS EXACT AND COMPLETE AND ITS USE DOES NOT RELIEVE THE CONTRACTOR OF ANY RESPONSIBILITY FOR LOSSES DUE TO ANY INACCURACIES. NOTIFY THE CIVIL ENGINEER OF ANY DISCREPANCIES FOUND.
4. CONTRACTOR TO FIELD VERIFY ALL DIMENSIONS AND REPORT ANY DISCREPANCIES TO THE ENGINEER.
5. DO NOT SCALE DRAWINGS FOR THE PURPOSE OF ESTABLISHING DIMENSIONS. CONTACT ENGINEER FOR VERIFICATION.
6. COORDINATE WITH THE ARCHITECTURAL, STRUCTURAL, MECHANICAL, PLUMBING, AND ELECTRICAL DRAWINGS AND VERIFY THE LOCATION OF ALL PROJECT REQUIREMENTS.
7. ALL SITE WORK SHALL BE IN ACCORDANCE WITH, OR SURPASS RECOMMENDATIONS OF SOILS REPORT, DRAWINGS, AND SPECIFICATIONS. IF A CONFLICTS ARISES, THE MORE PROHIBITIVE SHALL TAKE PRECEDENCE AND BE CONSIDERED TO BE THE INTENT OF THE PROJECT DOCUMENTS. IN ALL CASES, STRICTLY ADHERE TO DRAWINGS AND SPECIFICATIONS, UNLESS SOILS REPORT RECOMMENDATION EXCEEDS THE DRAWINGS AND SPECIFICATIONS.
8. ALL WORK PERFORMED IN THE CITY R.O.W. SHALL CONFORM TO THE CITY'S STANDARD DETAILS AND SPECIFICATIONS.

DEMOLITION NOTES:

1. ALL WORK SHALL BE IN ACCORDANCE WITH APPLICABLE LOCAL, STATE AND FEDERAL REGULATIONS.
2. ALL DEMOLITION AND CONSTRUCTION DEBRIS SHALL BE REMOVED FROM THE SITE AND DISPOSED OF IN ACCORDANCE WITH ALL APPLICABLE STATE AND FEDERAL RULES AND REGULATIONS.
3. THE CONTRACTOR IS RESPONSIBLE FOR REMOVAL, ADJUSTMENT, OR DEMOLITION OF ANY AND ALL EXISTING ELEMENTS WHICH MAY BE IN CONFLICT WITH THE WORK. COORDINATE WITH OWNER OF AFFECTED ELEMENT PRIOR TO WORK.

City of San Angelo
702 South Chadbourne Street
San Angelo, Texas 76903

RUFFINI CHAPEL
EAST AVENUE B
SAN ANGELO, TEXAS

SITE LAYOUT PLAN

REVISIONS

DWG BY: RTG	DWG DATE: FEB. 22, 2018
JOB NO: 17-E-0227	SHEET NO.
SCALE: 1"=20'	C1.1

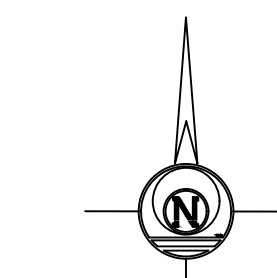

	EXISTING SPOT ELEVATION
	EXISTING CONTOUR
	PROPOSED CONTOUR
	PROPOSED SPOT ELEVATION

1. CONTOURS SHOWN HEREON BASED ON A SURVEY BY SKG ENGINEERING.
2. PROVIDE UNIFORM SLOPE BETWEEN SPOT ELEVATIONS AND CONTOURS EXCEPT AS REQUIRED IN 5 AND 6.
3. SPOT ELEVATIONS AND GRADES SHOWN HEREON REPRESENT THE FINISHED SURFACE. SITE CONTRACTOR TO ACCOUNT FOR THICKNESS OF BASE, PAVEMENT, CONCRETE, OR OTHER MISC. SURFACES TO BE APPLIED TO REACH FINAL GRADE.
4. CONTRACTOR TO FIELD VERIFY ALL ELEVATIONS AND REPORT ANY DISCREPANCIES TO THE ENGINEER.
5. SLOPES IN HANDICAP SPACES AND ACCESS AISLES SHALL NOT EXCEED 1:50 (2%) IN ALL DIRECTIONS.
6. ACCESSIBLE ROUTES WITH A SLOPE GREATER THAN 1:20 SHALL BE CONSIDERED A RAMP AND COMPLY WITH TAS. THE MAXIMUM CROSS SLOPE ALONG AN ACCESSIBLE ROUTE SHALL NOT EXCEED 2%.
7. PROVIDE POSITIVE DRAINAGE AROUND AND/OR AWAY FROM ALL BUILDINGS IN ACCORDANCE WITH THE BUILDING CODE AND CITY ORDINANCES.

8. THE FINISHED SURFACE OF THE CURB AND GUTTER AND PAVEMENT SHALL BE SMOOTH AND TRUE TO WITHIN 0.04 FEET OF THE ESTABLISHED LINE, GRADE, AND CROSS SECTION. AREAS THAT POND WATER GREATER THAN 1/4 INCH DEEP WILL NOT BE PERMITTED. THE CONTRACTOR SHALL BE RESPONSIBLE FOR CORRECTING DEFICIENT AREAS.

9. ALL SITE WORK SHALL BE IN ACCORDANCE WITH, OR SURPASS RECOMMENDATIONS OF SOILS REPORT, DRAWINGS, AND SPECIFICATIONS. IF A CONFLICTS ARISES, THE MORE PROHIBITIVE SHALL TAKE PRECEDENCE AND BE CONSIDERED TO BE THE INTENT OF THE PROJECT. IN ALL CASES, STRICT ADHERENCE TO THE DRAWINGS AND SPECIFICATIONS, UNLESS SOILS REPORT RECOMMENDATION EXCEEDS THE DRAWINGS AND SPECIFICATIONS.

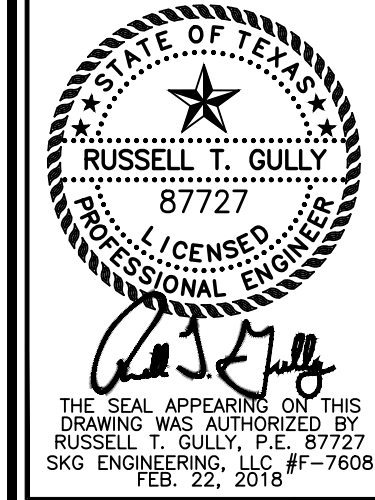

**City of San Angelo
702 South Chadbourne Street
San Angelo, Texas 76903**

**RUFFINI CHAPEL
EAST AVENUE B
SAN ANGELO, TEXAS**

SITE GRADING PLAN

<div style="text-align: center;">REVISIONS</div> <div style="border: 1px solid black; height: 150px; margin-top: 5px;"></div>	
DWG BY: <div style="text-align: center; border: 1px solid black; padding: 2px;">RTG</div>	DWG. DATE: <div style="text-align: center; border: 1px solid black; padding: 2px;">FEB. 22, 2018</div>
JOB NO. <div style="text-align: center; border: 1px solid black; padding: 2px;">17-E-0227</div>	SHEET NO. <div style="text-align: center; border: 1px solid black; padding: 2px; font-size: 2em;">C2.1</div>
SCALE: <div style="text-align: center; border: 1px solid black; padding: 2px;">1"=20'</div>	

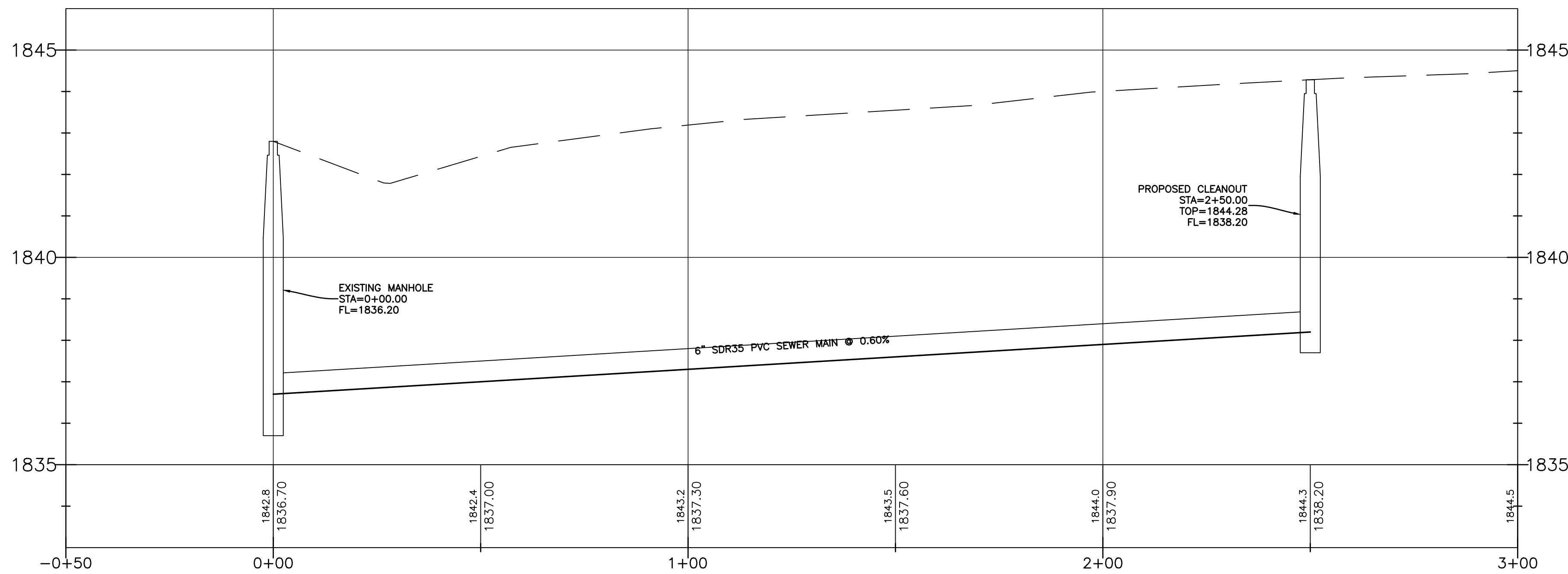
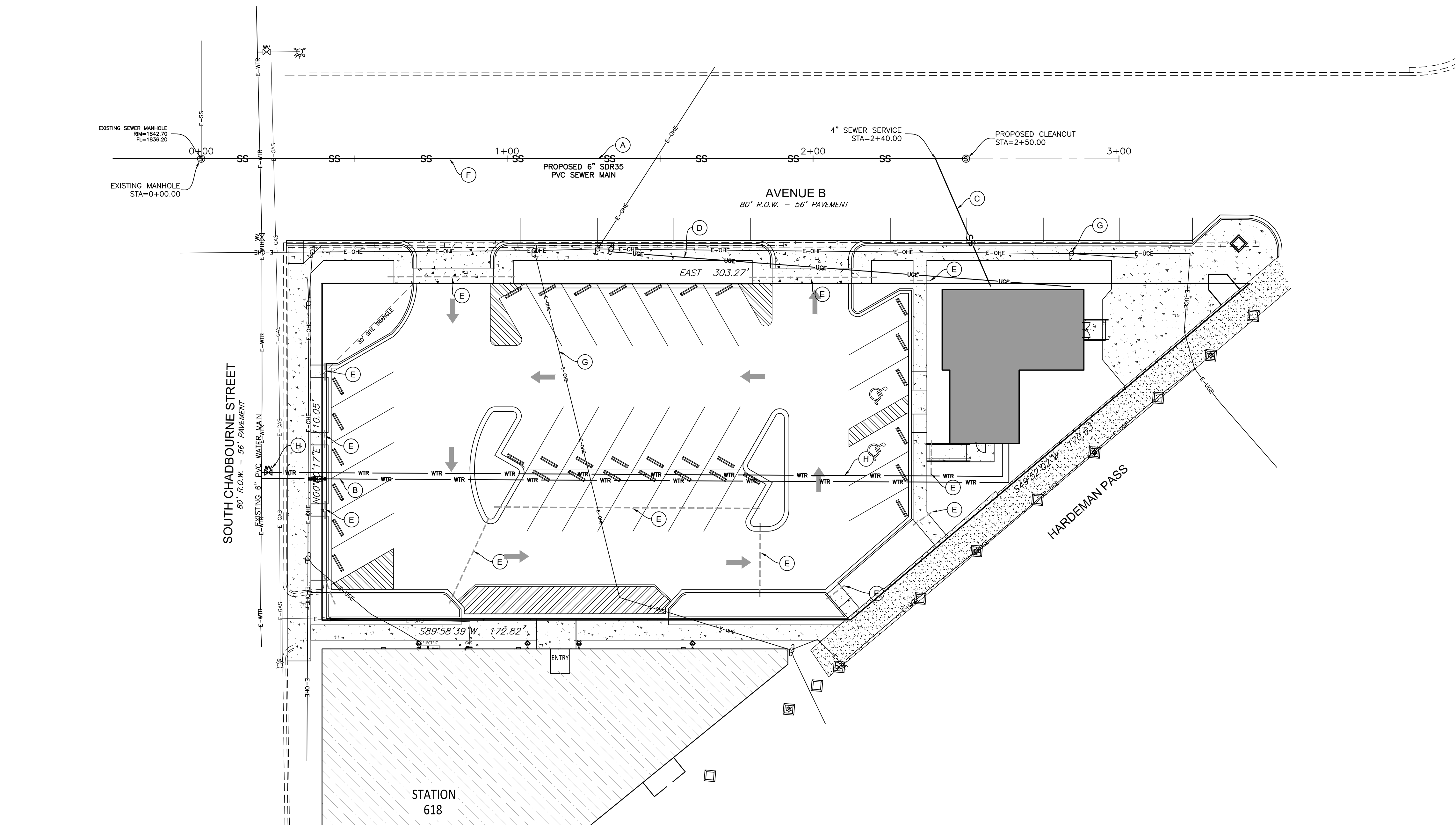

CITY OF SAN ANGELO
DEPARTMENT OF WATER UTILITIES

- ☐ ACCEPTED
☐ ACCEPTED AS NOTED

Drawing as to design only. Dimensions and location are not verified, contractor to verify as to plans and/or installation requirements.

DATE _____

KEYED NOTES:

- (A) 6" PVC SEWER MAIN.
- (B) 1-1/2" PVC SCH40 WATER SERVICE LINE, 1" METER, VALVES, AND VALVE VAULT. REFER TO PLUMBING PLANS FOR CONNECTION REQUIREMENTS AT BUILDING.
- (C) 4" PVC SEWER SERVICE LINE. REFER TO PLUMBING PLANS FOR CONNECTION REQUIREMENTS AT BUILDING.
- (D) TRANSFORMER ON UTILITY POLE. PROVIDE ALL CONDUITS FROM SERVICE POLE TO BUILDING. REFER TO ELECTRICAL PLANS FOR CONNECTION REQUIREMENT TO BUILDING.
- (E) 2" PVC SCH40 SLEEVES WITH CAP ENDS WITH 24" MIN. COVER. EXTEND A MINIMUM OF 24" BEYOND END OF STRUCTURE BEING CROSSED.
- (F) REPAIR UTILITY CUTS IN STREET PER COSA DETAIL S-Y-1.
- (G) COORDINATE WITH UTILITY COMPANY TO REMOVE EXISTING OVERHEAD UTILITY LINE.
- (H) TAPPING SLEEVE AND 4" GATE VALVE AT CITY MAIN. INSTALLATION OF THE FIRE SUPPRESSION LINE FROM THE VALVE AT THE CITY'S MAIN TO THE BUILDING SHALL BE INSTALLED BY A FIRE SUPPRESSION CONTRACTOR LICENSED THROUGH THE STATE OF TEXAS FIRE MARSHAL'S OFFICE.

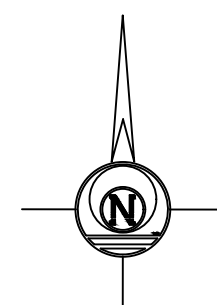

LEGEND

EXISTING		PROPOSED
E-WTR	WATER LINE	WTR
E-SS	SEWER LINE	SS
E-GAS	GAS LINE	GAS
E-OHE	ELECTRIC	UOE
	2" SLEEVE	----



UTILITY NOTES:

1. ALL WORK SHALL BE PERFORMED IN ACCORDANCE WITH THE CITY OF SAN ANGELO PUBLIC WORKS STANDARDS, APPLICABLE CODES, AND THE PROJECT SPECIFICATIONS. THE MORE STRINGENT STANDARD SHALL APPLY WHEN IN CONFLICT.
- APPLICABLE CODES:
2015 INTERNATIONAL BUILDING CODE
2006 NATIONAL ELECTRICAL CODE
2015 INTERNATIONAL PLUMBING CODE
2015 INTERNATIONAL MECHANICAL CODE
CITY OF SAN ANGELO ORDINANCES
2. EXISTING LINE LOCATIONS ARE SHOWN FOR THE CONVENIENCE OF THE CONTRACTOR IN ACCORDANCE WITH THE BEST INFORMATION AVAILABLE, BUT IS NOT GUARANTEED TO BE CORRECT OR COMPLETE.
3. THE CONTRACTOR IS RESPONSIBLE FOR VERIFYING THE EXACT SIZE, TYPE, AND LOCATION OF ALL UTILITIES AND PROTECTING AND REPAIRING THE SAME AT NO ADDITIONAL COST TO THE OWNER.
4. COORDINATE WITH THE ARCHITECTURAL, STRUCTURAL, MECHANICAL, PLUMBING, AND ELECTRICAL DRAWINGS AND VERIFY THE LOCATION OF ALL PROJECT REQUIREMENTS.
5. PROVIDE WATER SERVICE FROM EXISTING MAIN TO BUILDING. CONTACT THE CITY OF SAN ANGELO WATER UTILITY DEPT. AT 325.657.4209 FOR CHARGES OR FEES FOR WATER SERVICE CONNECTION. METERS AND VALVE BOXES TO BE FLUSH WITH GRADE. INSTALL BALL VALVE FOR CUTOFF VALVE IN BOXES. ALL WORK SHALL MEET THE REQUIREMENTS OF AND SHALL BE INSPECTED BY THE CITY OF SAN ANGELO.
6. PROVIDE NEW SEWER SERVICE FROM EXISTING MAIN TO BUILDING. CONTACT THE CITY OF SAN ANGELO WATER UTILITY DEPT. AT 325.657.4209 FOR CHARGES OR FEES FOR SEWER SERVICE CONNECTION. ALL WORK SHALL MEET THE REQUIREMENTS OF AND SHALL BE INSPECTED BY THE CITY OF SAN ANGELO.
7. PROVIDE ELECTRICAL SERVICE TO BUILDING. VERIFY ELECTRICAL SERVICE REQUIREMENTS WITH AEP. CONTACT BOBBY ELIZONDO AT 325.657.2872 FOR CHARGES, FEES, AND INSTALLATION REQUIREMENTS FOR ELECTRICAL SERVICE. CONTRACTOR IS RESPONSIBLE FOR MOUNTING METER BASE, METER, DITCHING, TRANSFORMER PAD, & ALL CONDUITS. AEP TO INSTALL PRIMARY CONDUCTOR TO TRANSFORMER.
8. PROVIDE TELEPHONE SERVICE TO BUILDING. VERIFY TELEPHONE SERVICE REQUIREMENTS WITH FRONTIER COMMUNICATIONS. INSTALL (2) 4" PVC CONDUITS TO SERVICE POINT. CONTACT FRONTIER AT 325.944.1191 FOR CHARGES, FEES, AND INSTALLATION REQUIREMENTS.
9. PROVIDE GAS SERVICE TO BUILDING. VERIFY GAS SERVICE REQUIREMENTS WITH ATMOS ENERGY. CONTACT EARLA AHRENS AT 325.481.3705 FOR CHARGES, FEES, AND INSTALLATION REQUIREMENTS.
10. CONTACT CRAIG THORNELL WITH SUDENLUNK AT 325.657.0581 FOR INTERNET, PHONE, AND CABLE TV SERVICE.



-

LEGEND

- PROPERTY LINE
 EXISTING CONTOUR
 PROPOSED CONTOUR
 LIMITS OF SOIL DISTURBANCE

GENERAL NOTES:

1. DRAINAGE PATTERNS AND APPROXIMATE SLOPES ARE SHOWN BY THE CONTOUR LINES.
2. LIMITS OF SOIL DISTURBING OPERATIONS ARE IDENTIFIED ON THE SITE MAP. THE AREA OUTSIDE THE SOIL DISTURBING AREAS WILL REMAIN UNDISTURBED NATURAL VEGETATION OR OTHER STABILIZED SURFACES.
3. LOCATIONS OF MAJOR STRUCTURAL CONTROLS ARE IDENTIFIED ON THIS SITE MAP. NATURAL VEGETATION AND SILT TRAPS ARE TO BE USED AS MAJOR STRUCTURAL CONTROLS TO PREVENT SEDIMENT FROM LEAVING THE SITE.
4. STABILIZATION PRACTICES ARE TO OCCUR OVER ALL AREAS IDENTIFIED ON THIS SITE MAP OR DISTURBED BY CONSTRUCTION ACTIVITIES. REVEGETATION OR MULCHING WILL OCCUR IN AREAS OF SOIL DISTURBANCE NOT COVERED BY A STABILIZED SURFACE.
5. THE MAP LOCATION OF THE STAGING AREA IS IDENTIFIED ON THIS SITE MAP. THIS WILL BE THE LOCATION OF OFF-SITE MATERIAL, WASTE, BORROW, FILL, OR EQUIPMENT STORAGE AREAS.
6. THE SURFACE WATER THAT IS ADJACENT OR IN CLOSE PROXIMITY IS THE CONCHO RIVER WHICH IS LOCATED APPROXIMATELY 0.1 MILES TO THE NORTH.
7. STORM WATER WILL NOT DISCHARGE DIRECTLY FROM THE SITE TO A SURFACE WATER BODY. THE DISCHARGE POINTS ARE IDENTIFIED HEREON.
8. EXCLUSION OF A "CONTROL MEASURE" ON THIS DRAWING DOES NOT EXEMPT THE OPERATOR OR OPERATOR OF HIS RESPONSIBILITY TO ADHERE WITH THE REQUIREMENTS OF THE STORMWATER POLLUTION PREVENTION PLAN. THIS DRAWING IS INTENDED TO BE REVISED AND AMENDED BY THE CONTRACTOR OR OPERATOR DURING THE CONSTRUCTION PROCESS TO ENSURE COMPLIANCE WITH THE TPODES GENERAL PERMIT.
9. SHOW THE LOCATION AND DATE OF INSTALLATION ON ALL CONSTRUCTION ENTRANCES, EQUIPMENT STORAGE LOCATIONS, MATERIAL STORAGE LOCATIONS, VEHICLE WASHES, AND SANITARY FACILITIES.
10. MARK THOSE AREAS WHERE VEGETATION HAS BEEN STRIPPED OR WHERE SOIL HAS BEEN DISTURBED. DATE OF DISTURBANCE SHALL BE PLACED IN THESE AREAS.
11. MARK THOSE AREAS WHERE CONSTRUCTION HAS CEASED AND PERMANENT VEGETATION IS BEING ESTABLISHED.
12. DATE REMOVAL OF EROSION CONTROL DEVICES AND NOTE REASON FOR REMOVAL IN THE SWPPP.
13. PRIOR TO BEGINNING OPERATOR SHALL MAKE COPIES OF PLAN. IF CURRENT PLAN BECOMES TOO CROWDED FOR USE, OPERATOR SHALL MAKE A "REVISED PLAN" WITH DATE OF CURRENT PLAN, AND BEGIN TO USE A COPY FOR NEW PLAN.



**City of San Angelo
702 South Chadbourne Street
San Angelo, Texas 76903**

**RUFFINI CHAPEL
EAST AVENUE B
SAN ANGELO, TEXAS**

EROSION CONTROL WORKMAP

<p style="text-align: center;">REVISIONS</p> <hr/> <hr/> <hr/> <hr/> <hr/> <hr/>	
DWG BY:	DWG. DATE:
RTG	FEB. 22, 2018
JOB NO.	SHEET NO.
17-E-0227	C4.1
SCALE:	
1"=20'	

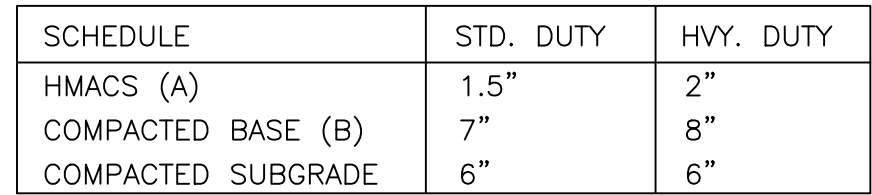

- 1
- HMAC PAVEMENT SECTION
- NO SCALE

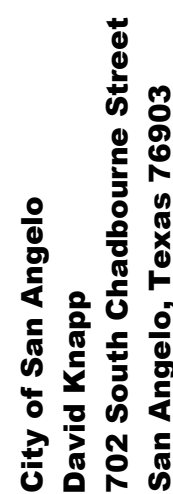
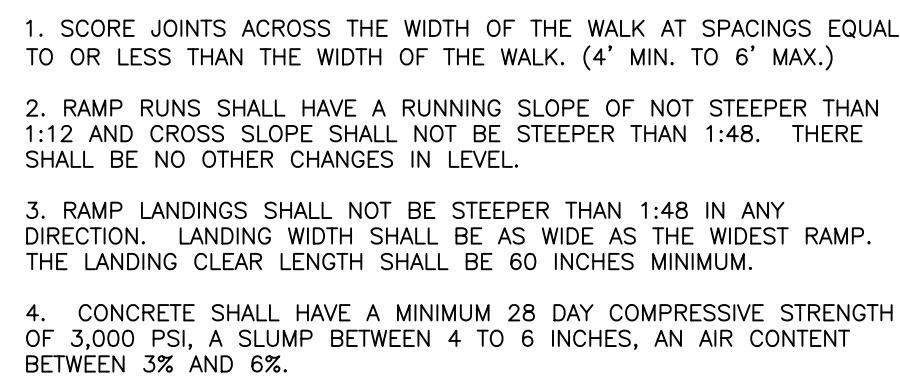
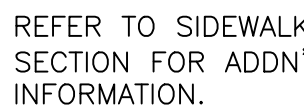
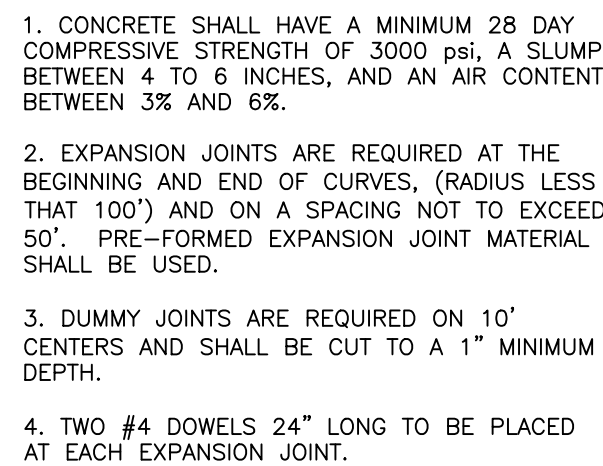
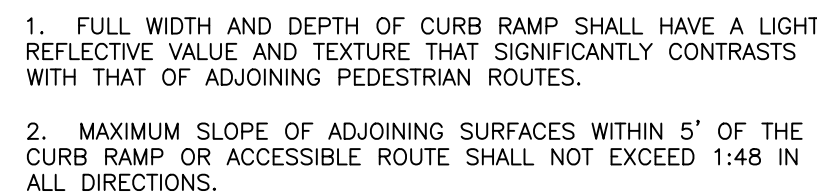
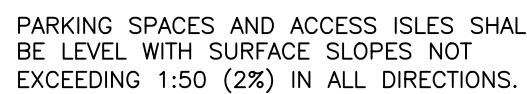
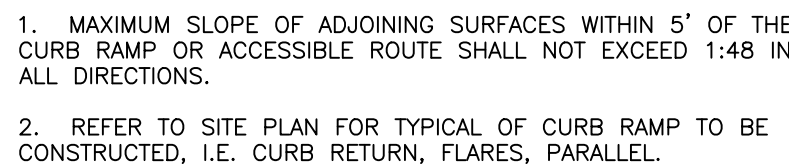
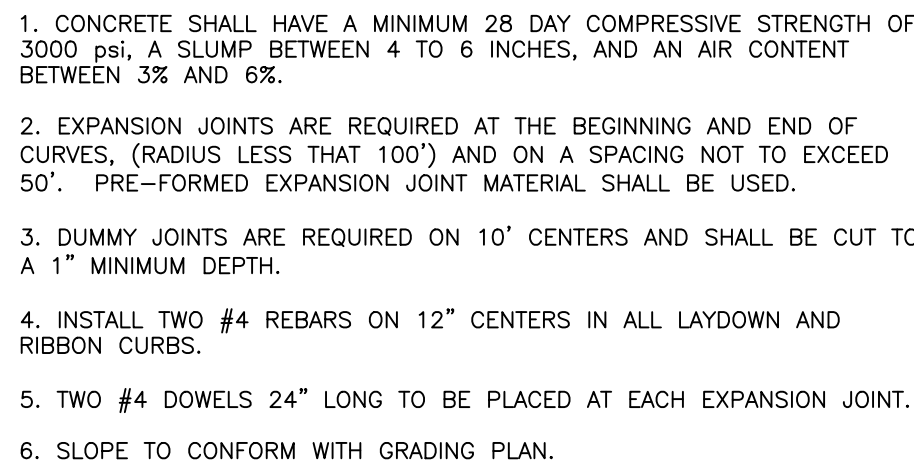
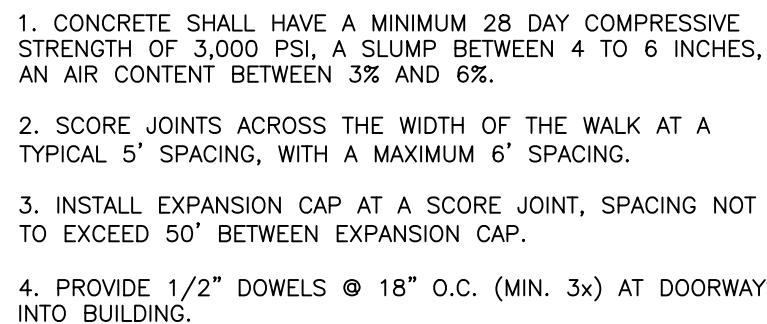

**RUFFINI CHAPEL
EAST AVENUE B
SAN ANGELO, TEXAS**

SITE DETAILS

<p style="text-align: center;">REVISIONS</p> 	
DWG BY: RTG	DWG. DATE: FEB. 22, 2018
JOB NO: 17-E-0227	SHEET NO. C5.1
SCALE: VARIES	

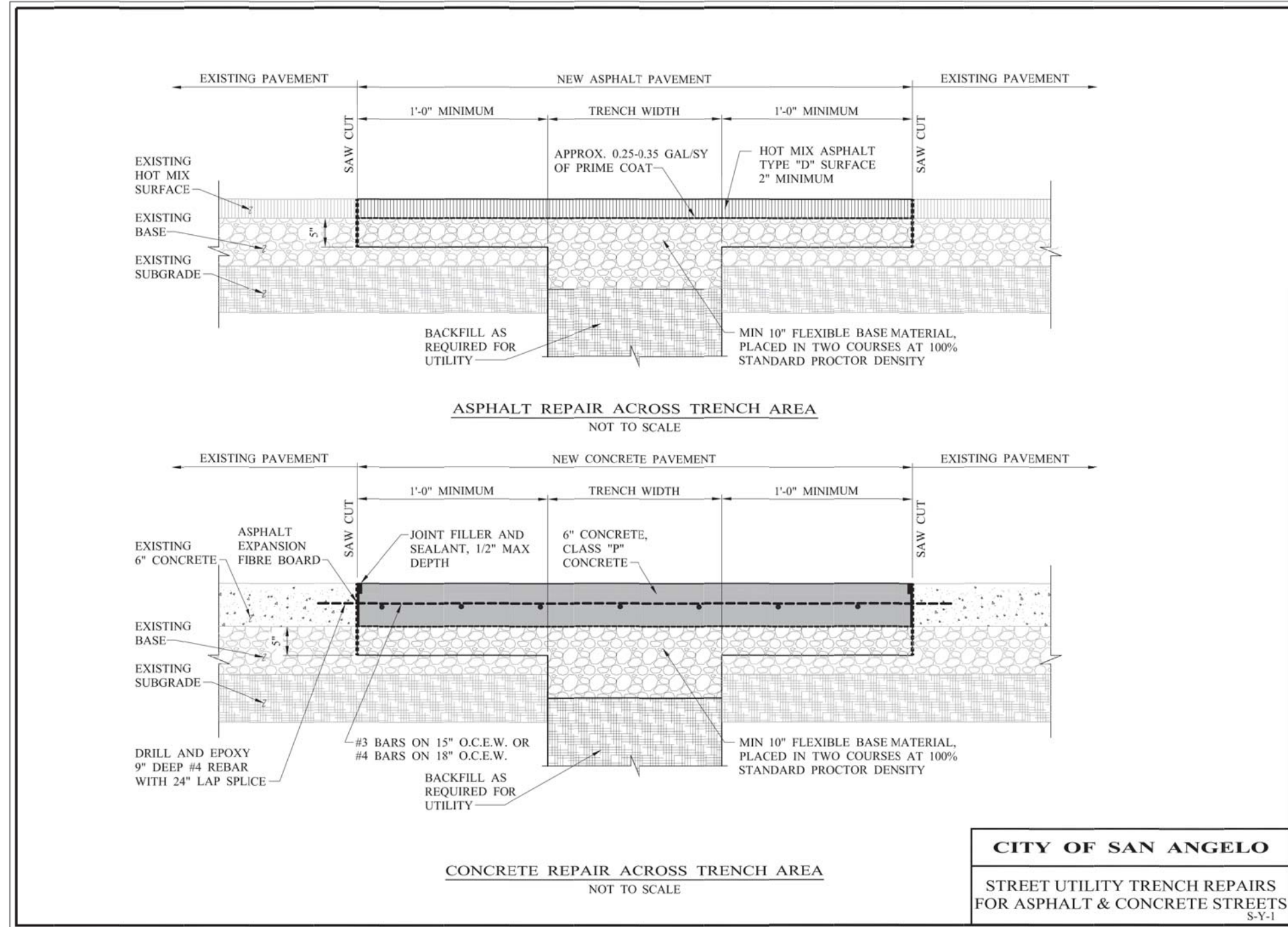
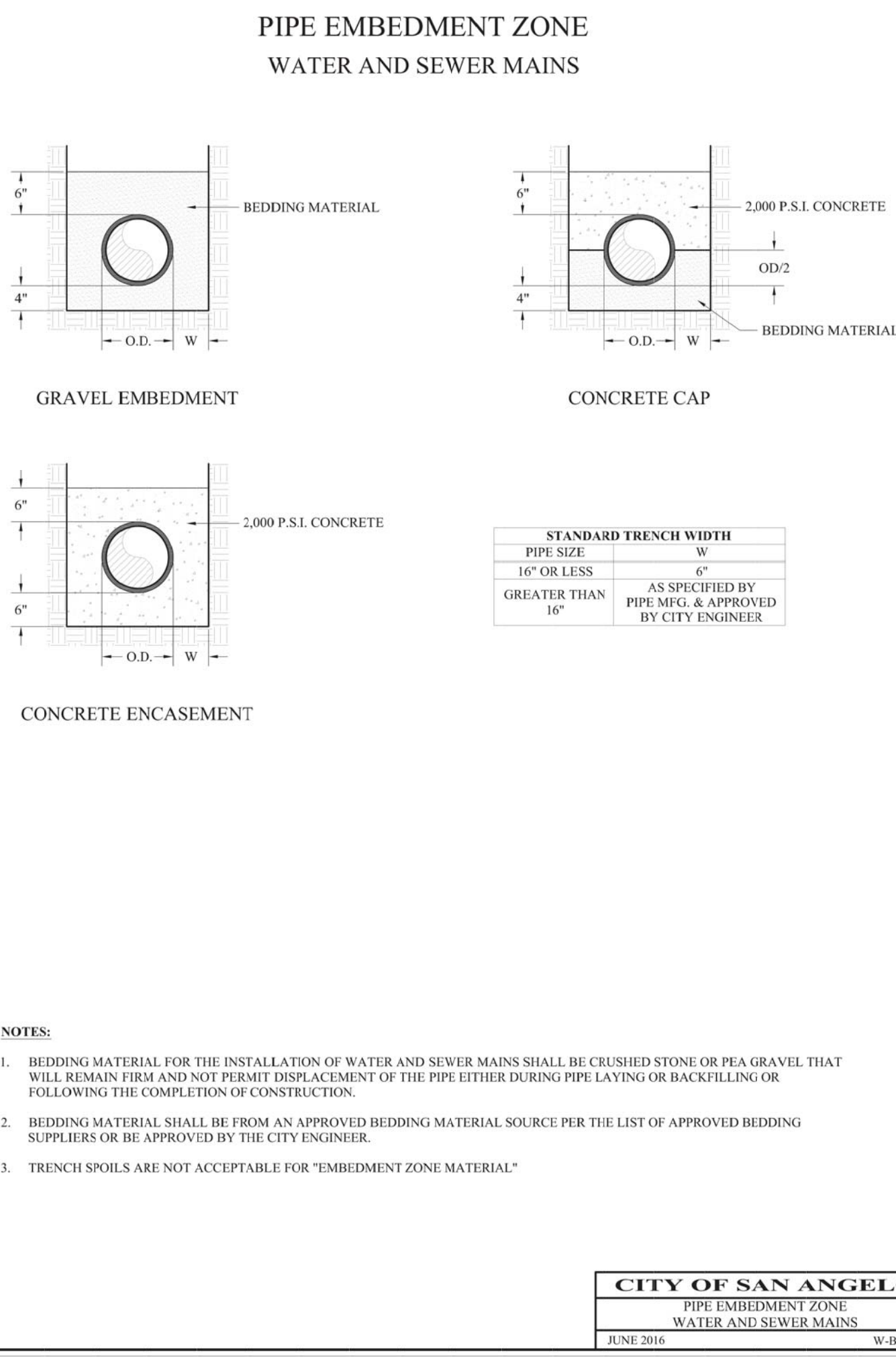
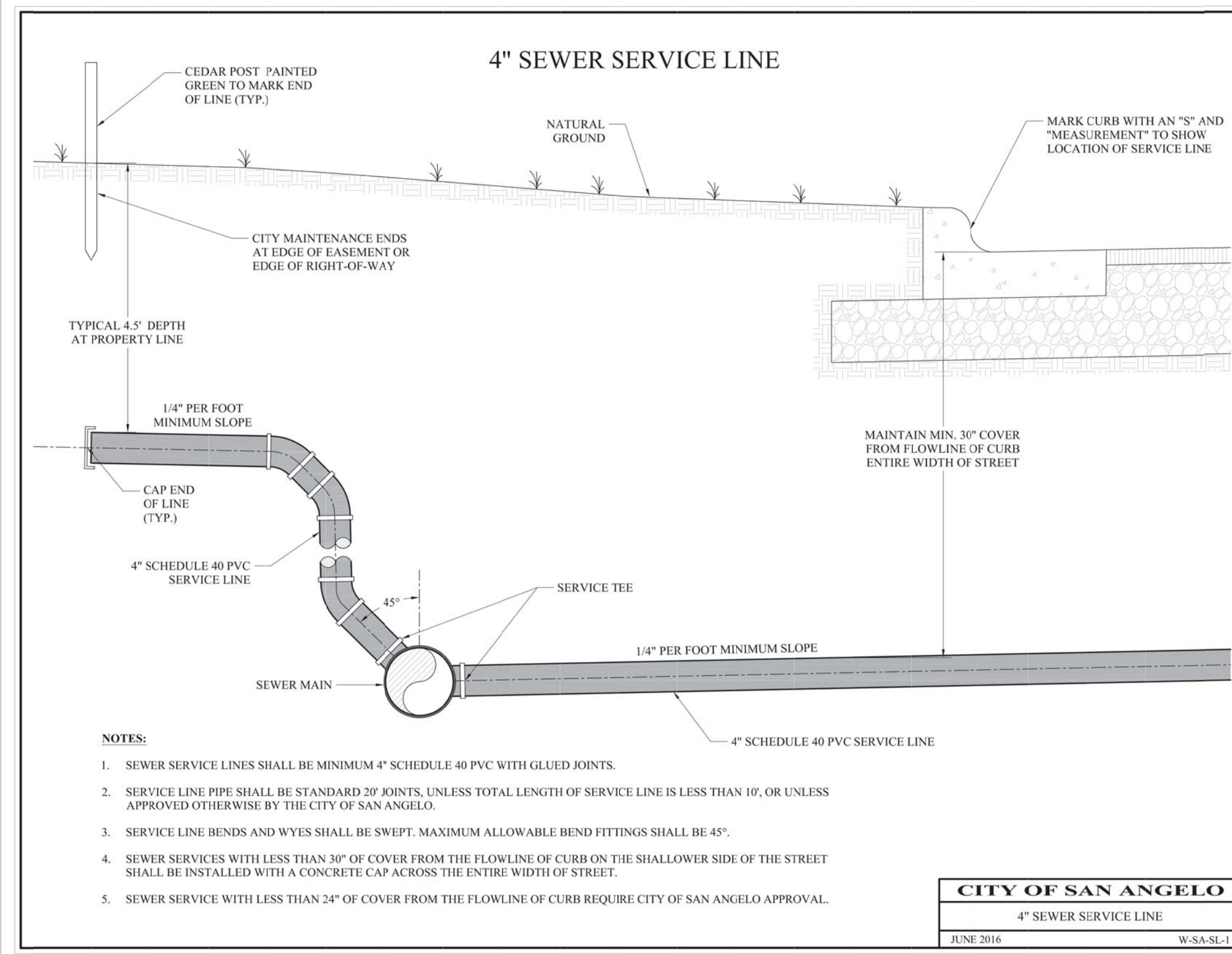
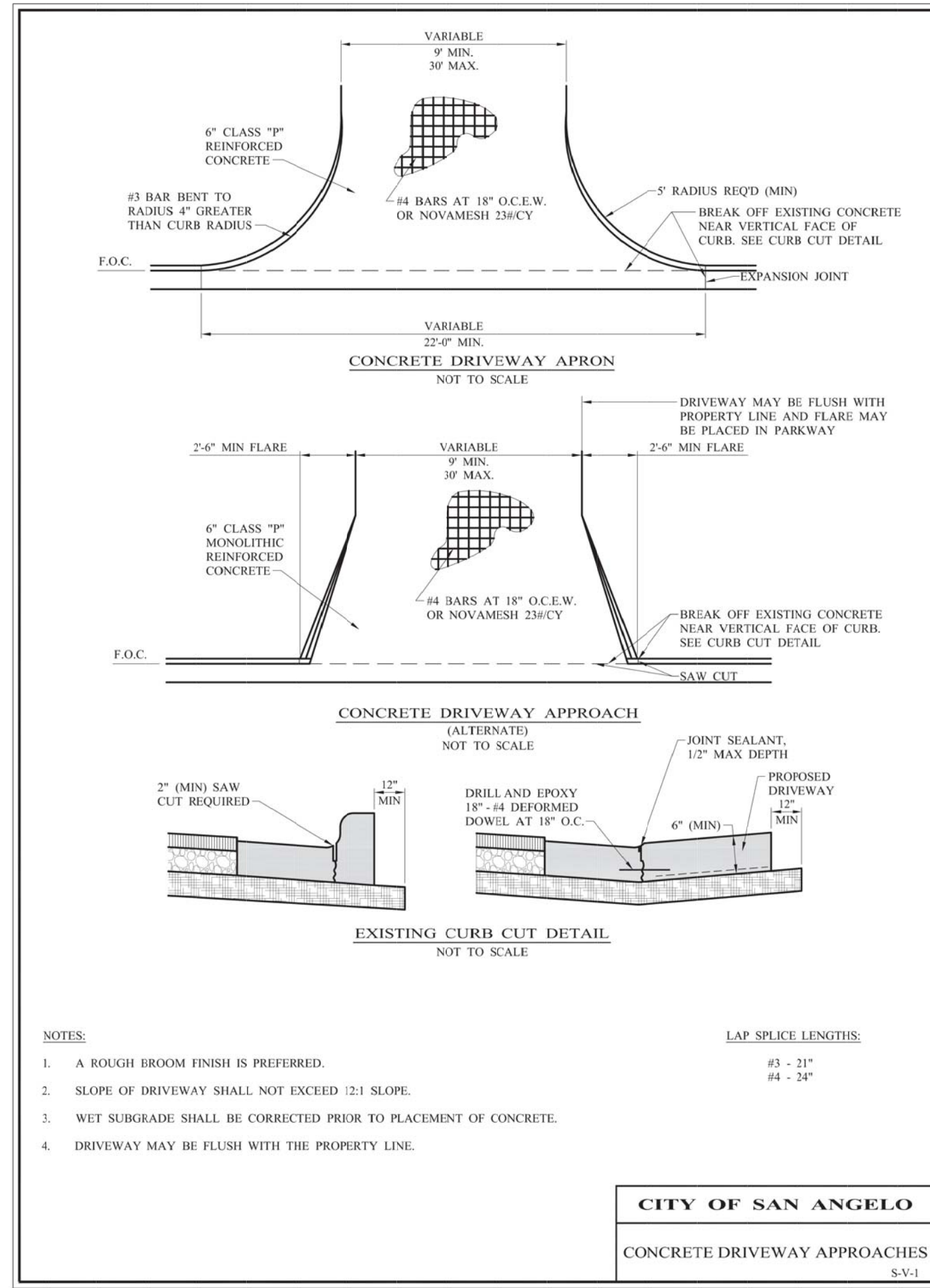
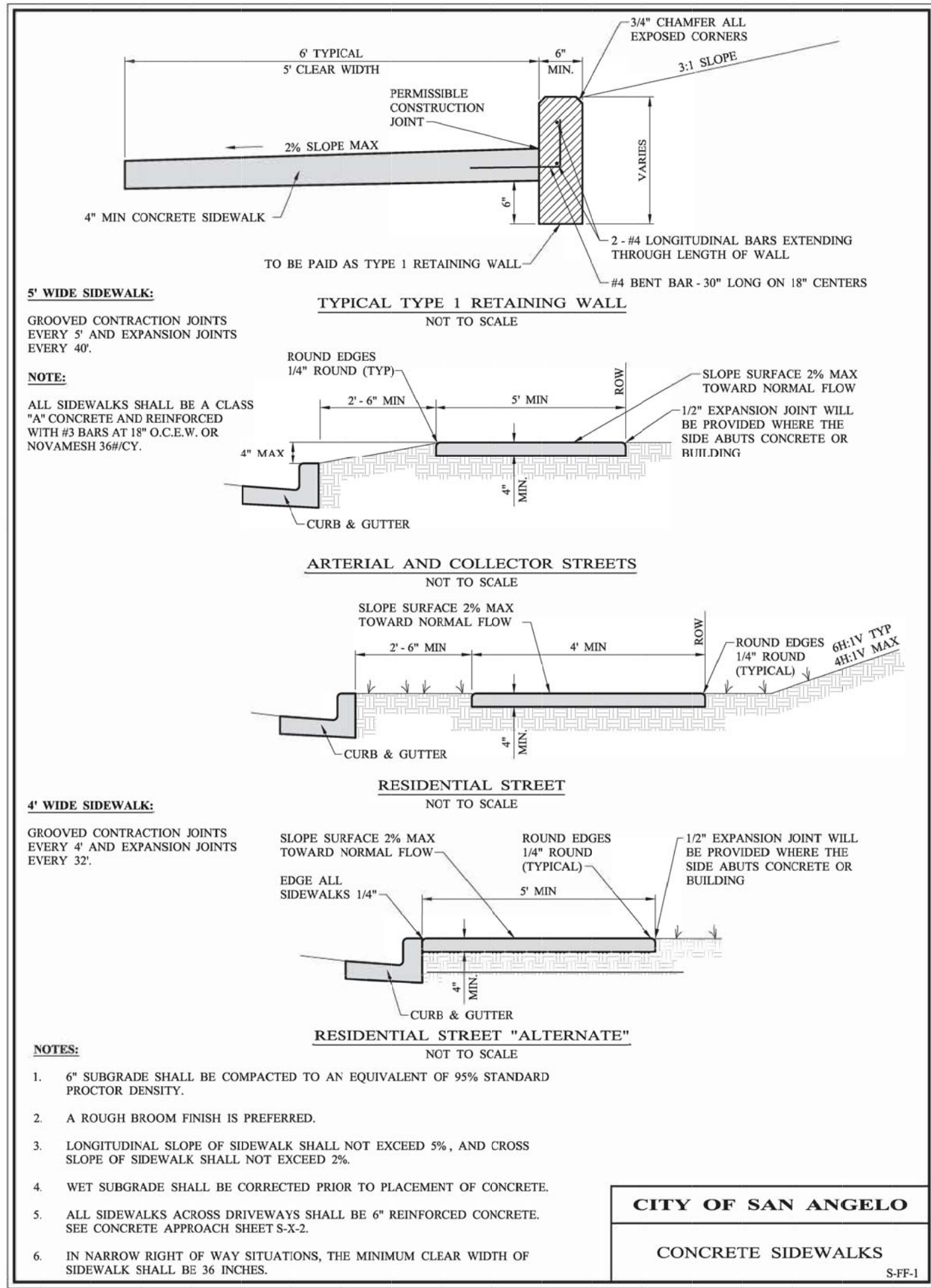
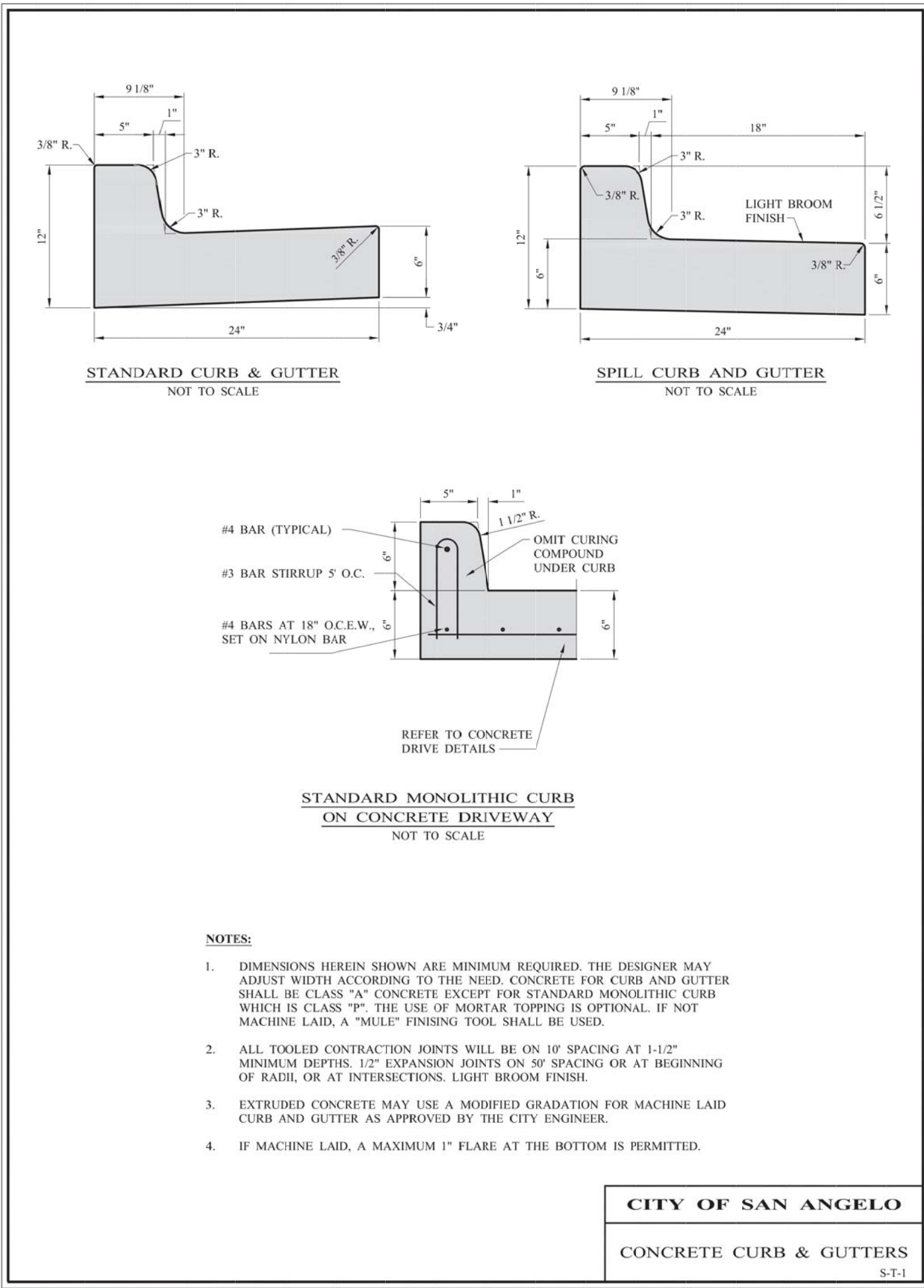



CITY ARCHITECT
702 SOUTH CHADBOURNE STREET
SAN ANGELO, TEXAS 76903
PHONE: 325-657-4279
EMAIL: david.knapp@cosatx.us

City of San Angelo
RUFFINI CHURCH PLAZA and PARKING LOT
11 EAST AVENUE B
SAN ANGELO, TEXAS

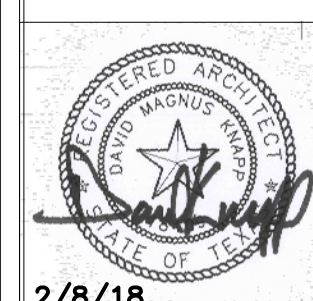

2/8/18

JOB #:
DATE: 2/8/18
DRAWN BY:
CHECKED BY:
REVISIONS:
FOR CONSTRUCTION

SHEET NO.
A-100
OF SHEETS

© The City of San Angelo, Texas 2014

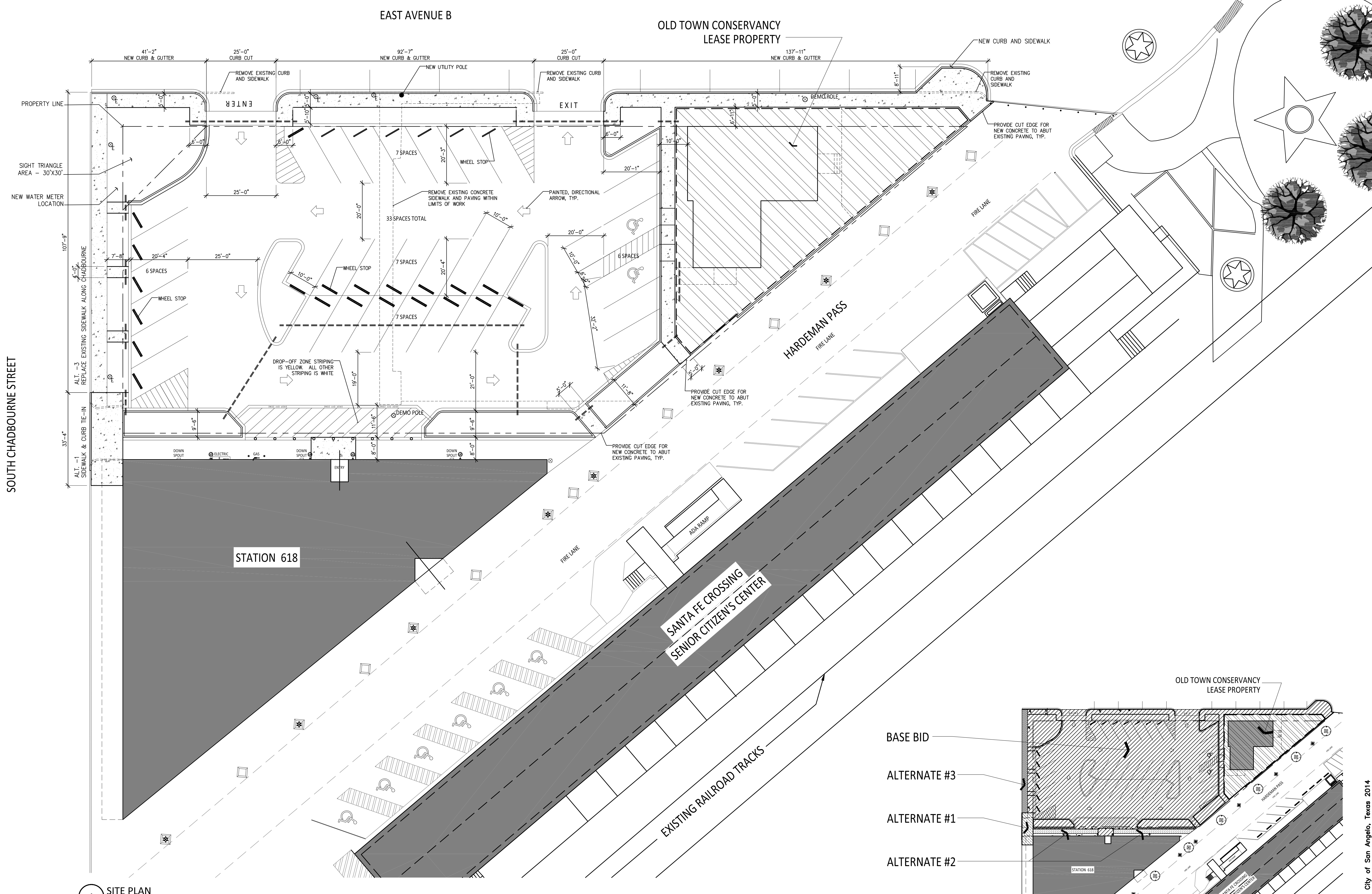

1 SITE PLAN
1/16" = 1'-0"

- BASE BID
- ALTERNATE #3
- ALTERNATE #1
- ALTERNATE #2

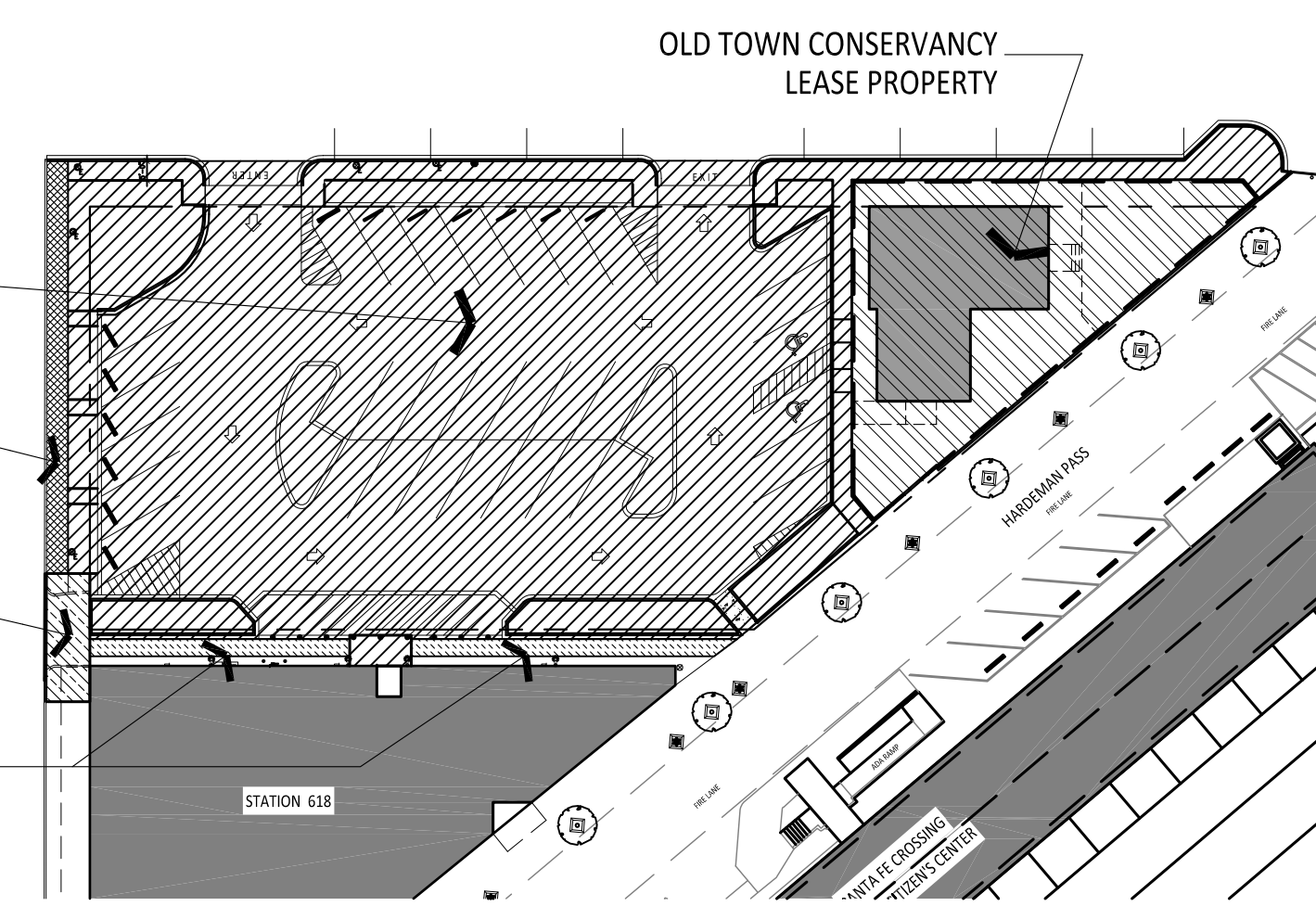

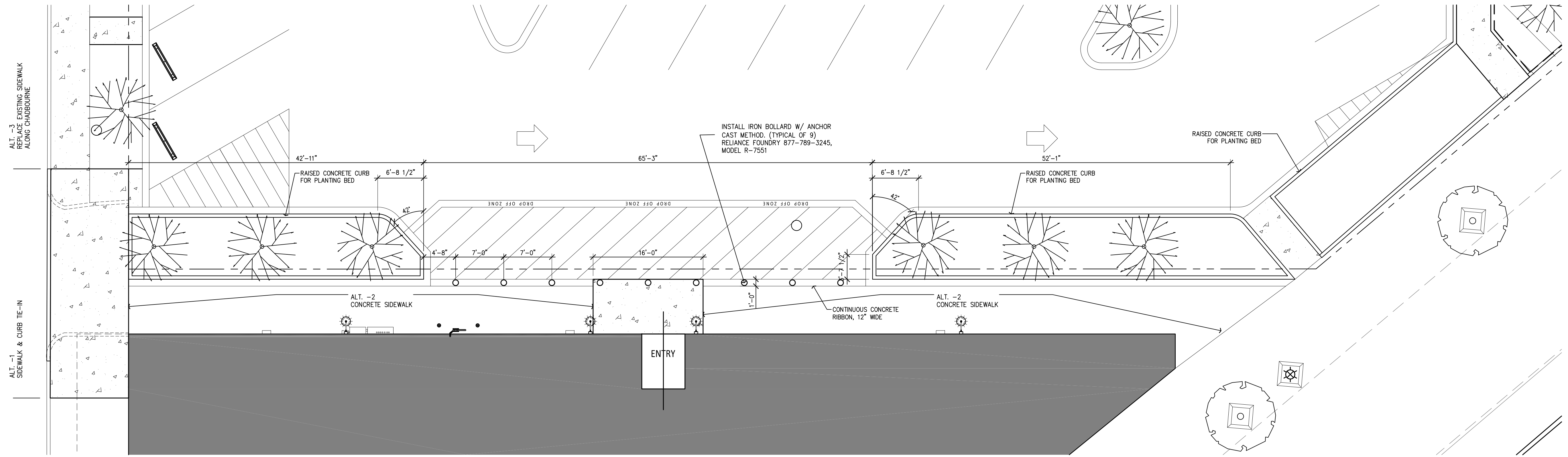

1 PLAN DETAIL
SCALE: 1/8" = 1'-0"

IRRIGATION METER, VALVES, LINES AND HEADS BY OWNER.

PLANTS AND INSTALLATION SHALL BE BY OWNER

CONTRACTOR TO PROVIDE IRRIGATION SLEEVES AS INDICATED UNDER PAVING AND CONCRETE. TYPICAL OF (2) 4" PVC AT EACH LOCATION. ENDS SHALL EXTEND 12" BEYOND EDGE OF PAVING. ENDS SHALL BE MARKED WITH STEEL ROD

DG - PROVIDE 4" OF 1/2" DECOMPOSED GRANITE IN BEDS WITH HEAVY DUTY WEED CLOTH BELOW

PB - PLANTING BED SHALL BE EXCAVATED 10" MINIMUM. PROVIDE 6" OF TOP SOIL TO FINISH

SOUTH CHADBOURNE STREET

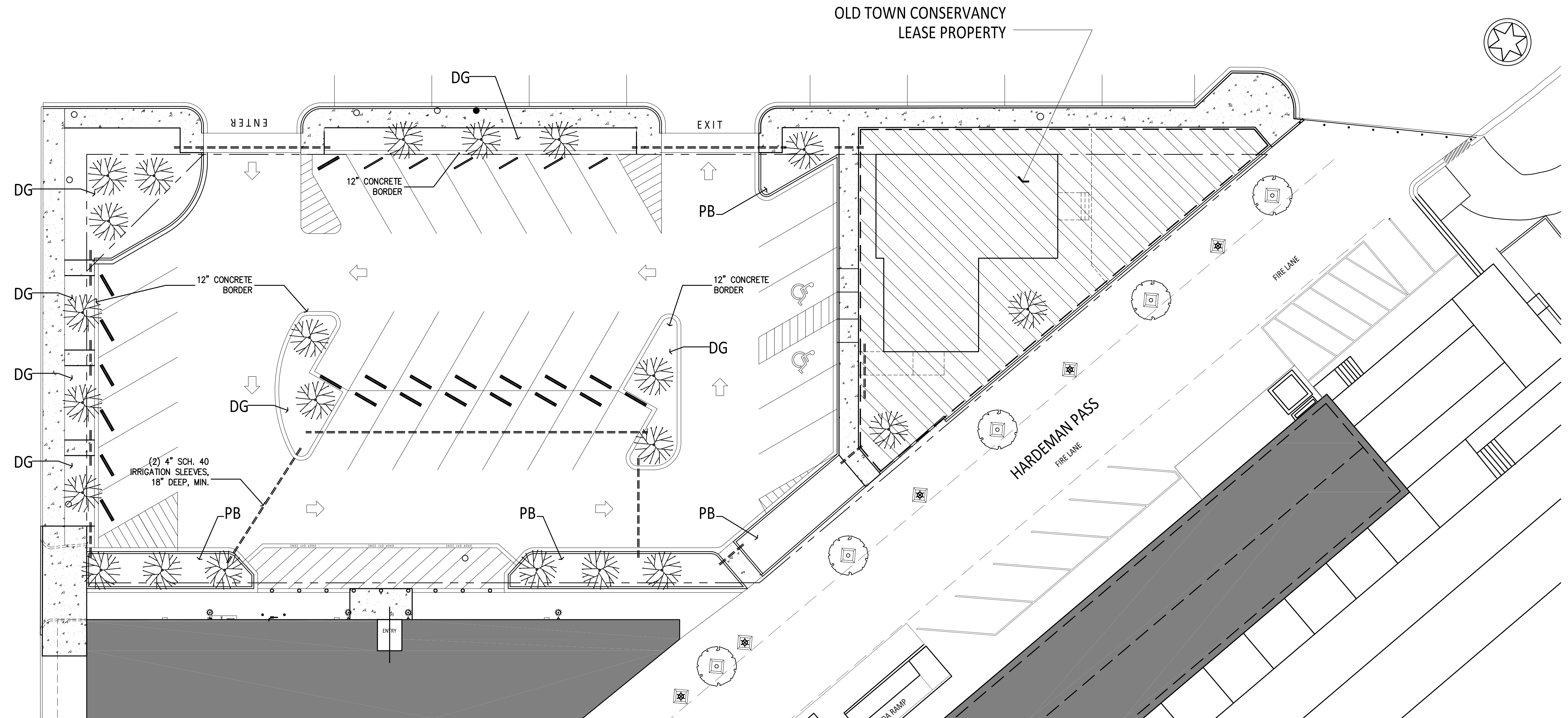

2 LANDSCAPE PLAN
SCALE: 1/16" = 1'-0"



CITY ARCHITECT
702 SOUTH CHADBOURNE STREET
SAN ANGELO, TEXAS 76903
PHONE: 325-657-4279
EMAIL: david.knapp@cosatx.us

City of San Angelo
RUFFINI CHURCH PLAZA and PARKING LOT
11 EAST AVENUE B
SAN ANGELO, TEXAS

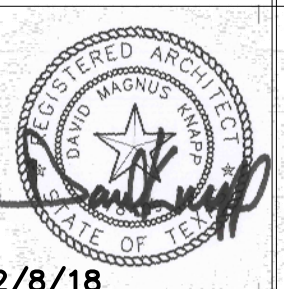

2/8/18

JOB #:
DATE: 2/8/18
DRAWN BY:
CHECKED BY:
REVISIONS:
FOR CONSTRUCTION

SHEET NO.
A-101
OF SHEETS